

■ ALA Free Straight Plug (Multipole)

- Connector series: ALA
- Contact: Hermaphroditic
- Locking type: Self-locking
- Orientation type: Straight
- Part No.: ALA.XS.30X.CLLCXX
- Mated with: PSA series(Multipole)

Note: "X" refers to part number definition on page 81

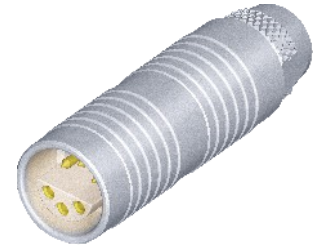
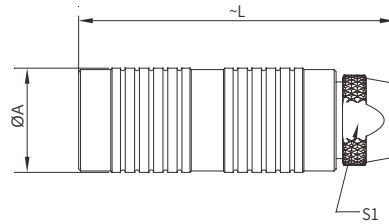

■ General Information

Ambient temperature:	-55°C~+250°C
Endurance:	>5000 cycles
Insulator:	PEEK
Housing:	Brass with Cr plated
Connector contacts:	Brass with gold plated

Insulation resistance:	≥100MΩ
IP rating:	IP 50
Shielding efficiency:	at 10MHz>75dB/at 1GHz>40dB
Salt spray corrosion test:	>144h

Size	Dimensions(mm)		
	A	L	S1
0S	8.9	33.5	6.5
1S	11.9	40.5	8.5
2S	14.8	50.0	11.0

■ FRP Fixed Straight Socket, Nut Fixing, Protruding Shell (Multipole)

- Connector series: FRP
- Contact: Hermaphroditic
- Locking type: Self-locking
- Orientation type: Straight
- Part No.: FRP.XS.30X.CLL
- Mated with: PSA series

Note: "X" refers to part number definition on page 81

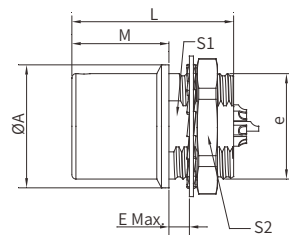

■ General Information

Ambient temperature:	-55°C~+250°C
Endurance:	>5000 cycles
Insulator:	PEEK
Housing:	Brass with Cr plated
Connector contacts:	Brass with gold plated

Insulation resistance:	≥100MΩ
IP rating:	IP 50
Shielding efficiency:	at 10MHz>75dB/at 1GHz>40dB
Salt spray corrosion test:	>144h

Size	Dimensions(mm)						
	A	e	E	L Max	M	S1	S2
0S	10	M9*0.6	2.0	20.5	12.5	8.2	11
1S	14	M12*1.0	3.5	22.0	12.0	10.5	14

Note: Panel cut-out (page 164)